

FTTP Blown Cable Micro Duct Customer Lead-In Internal

Lead-in for Microduct through Wall with



Features

- Low Visual impact Grey Colour
- 30mm Bend Radius for Cable Blowing

Design

- 1 x Internal CLI Cover
- 1 x Internal CLI Base
- 2 x screws

Application

To be installed externally where micro ducts travel through subscribers walls. The larger radius achieved enables fibres to be blown through the wall transition.

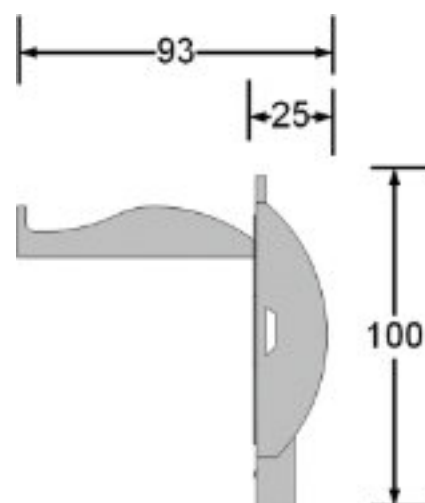
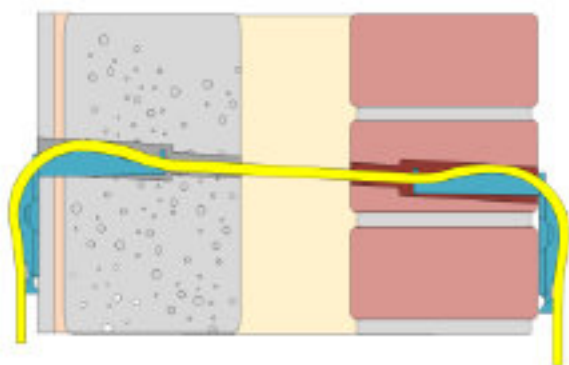

Ordering Information

10011216

ISCVM-BFT-CLI-INT-DCT-GRY

FTTP Blown Cable Micro Duct Customer Lead-In - Internal - Grey - Inc:
Cover / Base & 2 Screws [No Gas Block Capability]