

FTTP Blown Cable Micro Duct Customer Lead-In Internal

Lead-in for Microduct through Wall with



Features

- Low Visual impact White Colour
- 30mm Bend Radius for Cable Blowing

Application

To be installed externally where micro ducts travel through subscribers walls. The larger radius achieved enables fibres to be blown through the wall transition.

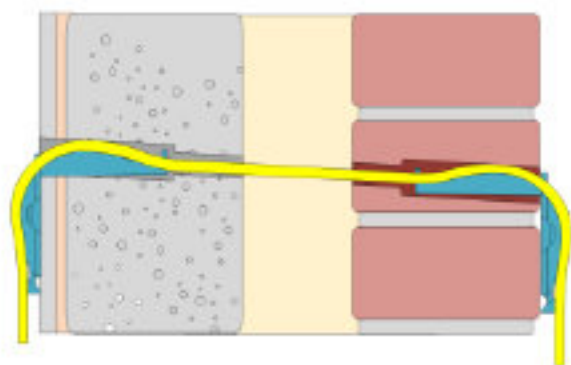

Design

- 1 x Internal CLI Cover
- 1 x Internal CLI Base
- 2 x screws

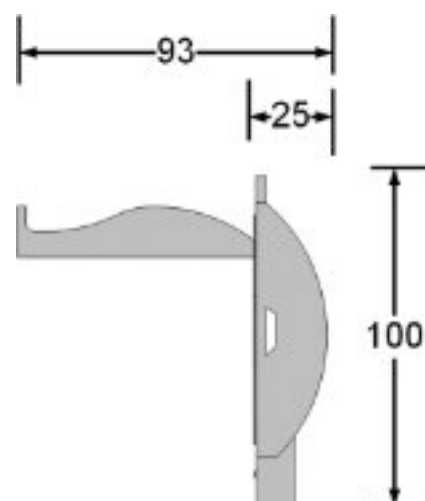

Ordering Information

10011215

ISCVM-BFT-CLI-INT-DCT-WHT

FTTP Blown Cable Micro Duct Customer Lead-In - Internal - White - Inc:
Cover / Base & 2 Screws [No Gas Block Capability]