

# FTTP Blown Cable Micro Duct Customer Lead-In External

Lead-in for Microduct through Wall with Gasblock housing



## Features

- Low Visual impact Grey Colour
- 30mm Bend Radius for Cable Blowing
- Suitable for Gasblock

## Design

- 1 x External CLI Cover
- 1 x External CLI Base
- 1 x OH Adapter
- 4 x screws

## Application

To be installed externally where micro ducts travel through subscribers walls. The larger radius achieved enables fibres to be blown through the wall transition.

Gasblock couplers can be housed within the Leadin

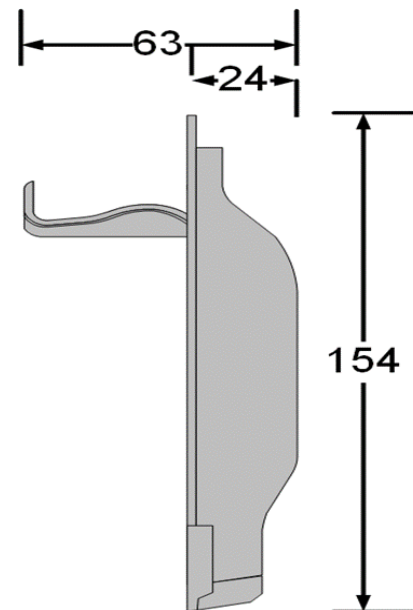
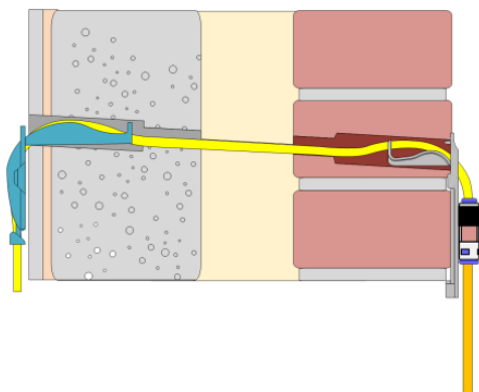

## Ordering Information

10011214    ISCVM-BFT-CLI-EXT-DCT-GRY

FTTP Blown Cable Micro Duct Customer Lead-In - External- Grey

## Installation Process – lead-in With Connector or Gas Block

### CUSTOMER WALL

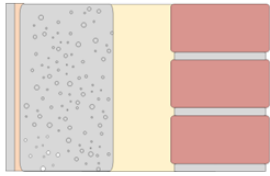

### DRILL THROUGH CAVITY

Normal installation process  
Hole Should be enlarged to 20mm for duct arc.

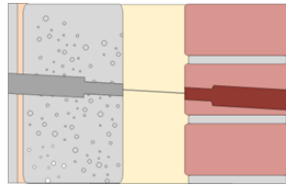

### FIT LEADIN OVER DUCT – FEED DUCT

Duct should pass through the cavity without kinking.

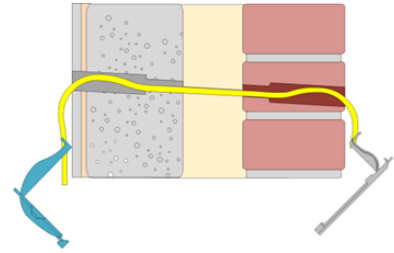

### FIT LEADINS TO WALL

Screw Fix Recommended  
Silicone Sealant Recommended to Provide Water seal

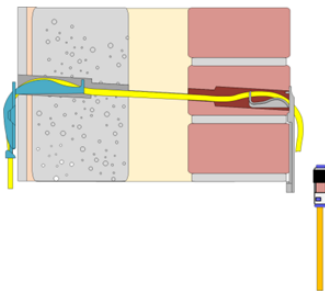

### FIT LEADINS TO WALL

Attach Gas Block Connector\*

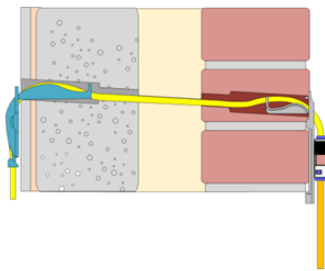

### FIT LEADIN COVERS

Gas Block Covers Benefit from Screw Fixing

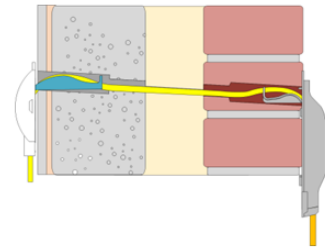

**\*Gas Block to be tightened after Fibre installation**